

ITEM NO.	PART NUMBER	DESCRIPTION	QTY
1	212L085	STEEL RING SEGMENT, 12m FOUND. KIT	6
2	212L495	WOOD RING SEGMENT, 12m FOUND. KIT	6
3	3HTG0001	THREADED ROD, 1.75 NC X 55" GALV.	36
4	3HNG0012	NUT, 1-3/4 NC GRADE 5 GALVANIZED	144
5	3HWG0012	WASHER, 1-3/8 SAE FLAT STD OD, GALV	144

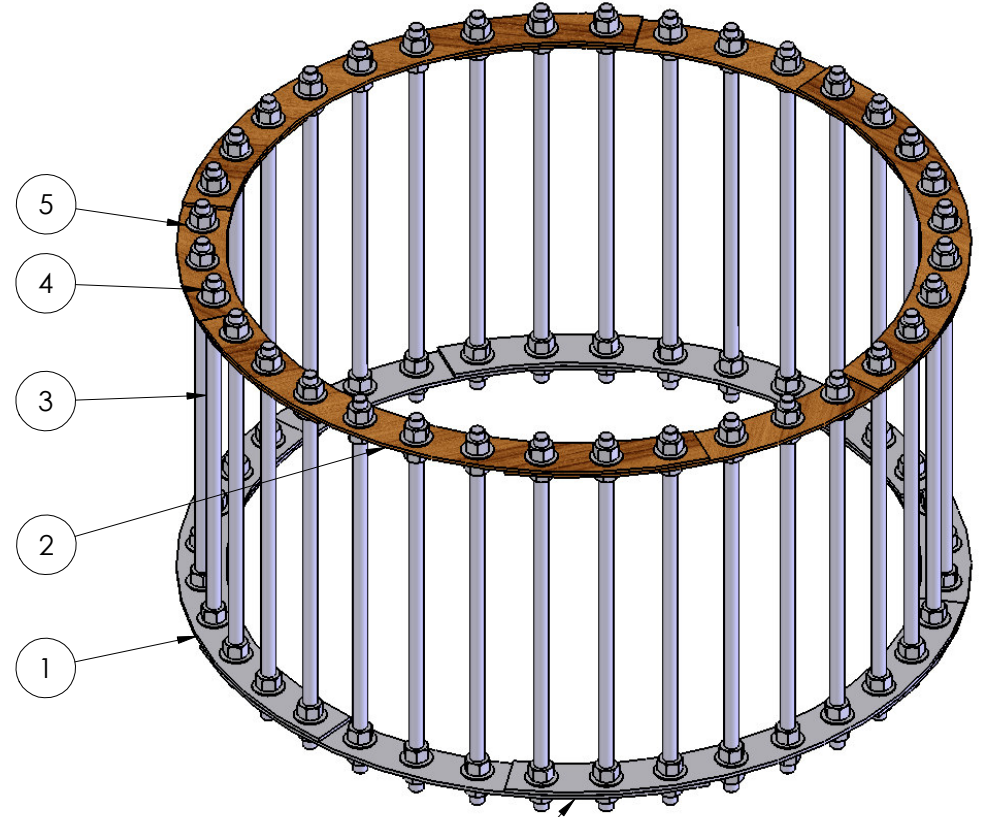
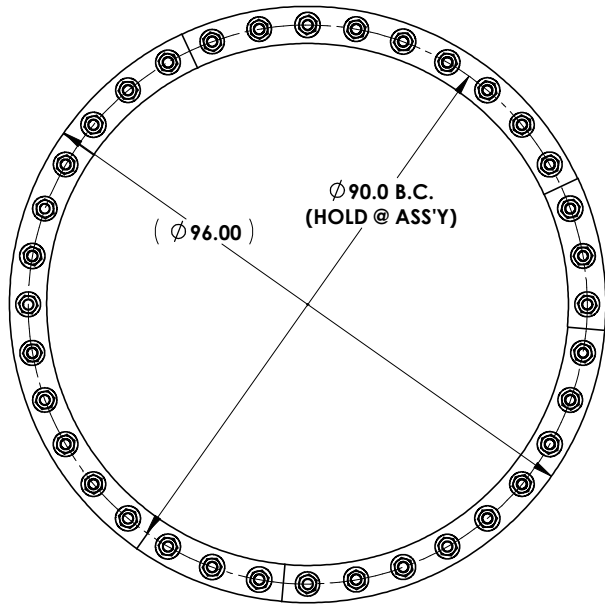
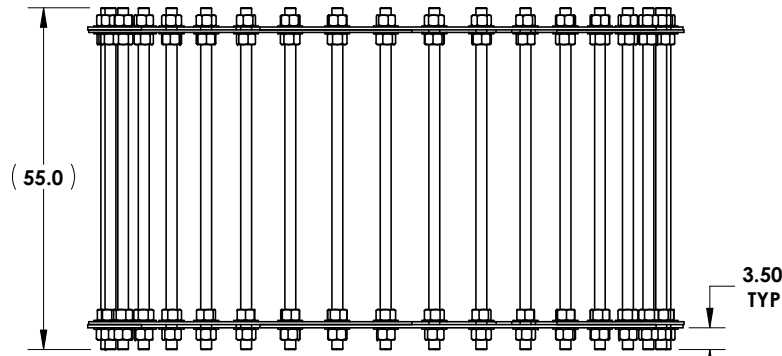

**NOTE: OVERLAP RING SEGMENTS BY THREE HOLES AS SHOWN!**

PROPRIETARY AND CONFIDENTIAL  
THE INFORMATION CONTAINED IN THIS  
DRAWING IS THE SOLE PROPERTY OF  
PATRIOT ANTENNA SYSTEMS. ANY  
REPRODUCTION IN PART OR AS A WHOLE  
WITHOUT THE WRITTEN PERMISSION OF  
PATRIOT ANTENNA SYSTEMS IS PROHIBITED.

MATERIAL: SUB-ASSY (SEE BOM ABOVE)	CHECKED IN:	NAME	DATE	<b>PATRIOT</b> 704 North Clark Street - Albion, MI 49224 USA TITLE: <b>KIT, BOLT AND TEMPLATE FOR 12m ANTENNA</b>
	DRAWN BY:	JBP	7-29-08	
	ENG APPR:	KS	JUL08	
UNLESS OTHERWISE SPECIFIED: DIMENSIONS ARE IN INCHES: CORNERS ARE AT 90°	NOTES:		SIZE DWG. NO. <b>B PRT-BTK1200</b>	REV <b>000</b>
Tolerances: FRACTIONAL: ±1/8" ANGULAR: ±1° X ±.06" XX ±.020" XXX ±.005"	SCALE: 1:32		SHEET 1 OF 1	VAULT: